

NOTES TO APPLICANT:-

Maximum height at which meters can be fitted is 1700mm from top of meter to finished floor level. (This is to ensure maximum length of meters tails is not exceeded).

Minimum height at which meters can be fitted is 300mm from bottom of meter to finished floor level.

Minimum size of trunking is 150mm x 150mm except above and below the multi-way board where a minimum size of 2250mm x 225mm is required.

Customer intake equipment shown is indicative only and should be designed by the applicant to meet their specific requirements.

Maximum number of usable ways is 30no. For a communal meter position arrangement, a maximum of 12no. single-phase meters can be supplied via tails, plus a three-phase landlord supply using the bottom cable chamber entry shown for the remaining 15no. services and meters the top entry cable chamber must be used.

Meters supplied via tails must only be terminated to either the middle or lower bus-bar of the multi-way board (top entry).

Meters supplied via tails must only be terminated to either the middle or upper bus-bar of the multi-way board (bottom entry).

It is a condition of our service quotation for multi-way intakes that the electrical contractor submits a scaled sketch of the proposed equipment layout for our approval prior to acceptance of quotation.

All trunking and meter tails provided and installed by Applicant. Meter tails terminated to JE plant by JE personnel only.

Max 3m length meter tails. Meter tails are not to transit between floors.

For all meter dimensions, Refer to JE drawing 80-N21.

Supply position must be secure and environmentally safe. JE equipment shall only be fixed onto a visible 18mm fire rated (BS-1-D0 or ASTM E84 class A certification) or equivalent. The applicant's contractor shall ensure the backboard is adequately fixed to any substrate layers, but not to the detriment of the enclosures fire rating.

No other equipment may be installed over the top of any JE cables or equipment.

JE will not install into any cupboard that has water services, plumbing, drainage, or raw water pipes within it.

Fireproofing of the cable slots between floors should be carried out with adequately rated removable fire bags provided and installed by the applicant.

- Design dimensions and spacing:-
- 1) Single-phase meter dimensions = 145mm wide x 150mm tall
 - 2) Three-phase meter dimensions = 160mm wide x 220mm tall
 - 3) Single-phase switch-use dimensions = 50mm wide x 200mm tall
 - 4) Three-phase switch-use dimensions = 35mm wide x 200mm tall
 - 5) Vertical spacing between meter / switch-chambers / trunking = 20mm
 - 6) Vertical spacing above JE meters = 30mm
 - 7) Superimposed door outline dimensions = 198mm x 762mm each

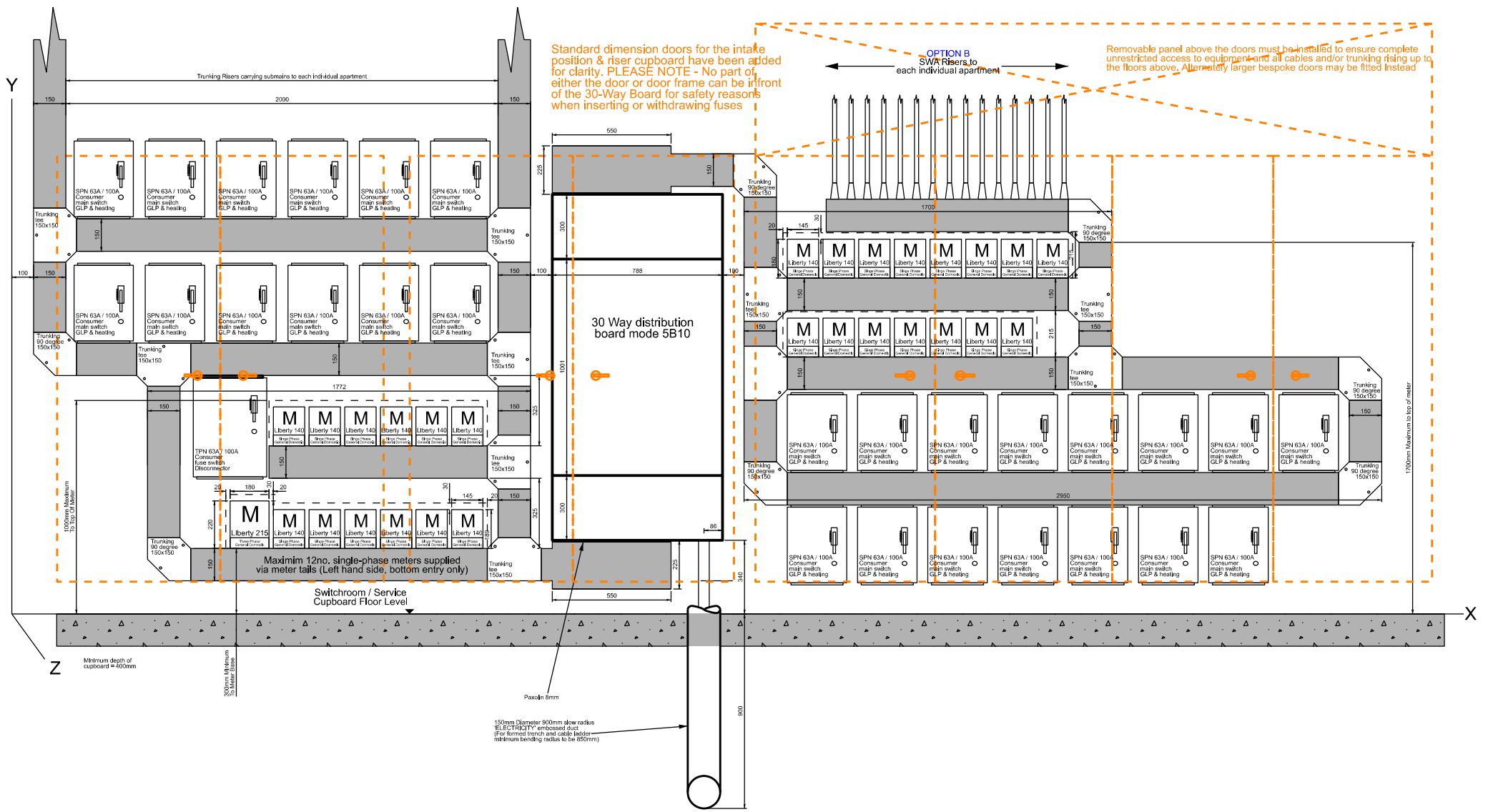

Type and quantity of JE services are indicative only to assist when the applicant constructs their own site specific drawings after consultation with JE.

Rev	Date	Description	Drn	Appd
A	04-12-24	Notes altered	AB	ML
-	25-01-24	Original Issue	TSB	ML

Project

Title

General Arrangement Drawing - 30-Way Distribution Board 5B10 without LV rising Main showing the maximum quantity of communally metered Single-Phase services from both top & bottom cable chambers, & also including a communal Three-Phase Landlords service from the bottom cable chamber.

The Intellectual Property Rights (IPR) ie. Patents, Copyright, Trade Secrets, Design Rights etc., remain strictly the property of Jersey Electricity Company plc and may not be copied and /or reproduced in any form without their 'Express Permission'.

Jersey Electricity

The Powerhouse PO Box 45 Queen's Road St. Helier Jersey JE4 8NY.
Tel - 01534 505000 Fax - 01534 505011 e-mail - jec@jec.co.uk

Drg. No. **740-N21**

Revision **A**